

Ultra-Fast Recovery Diodes 16A FRED

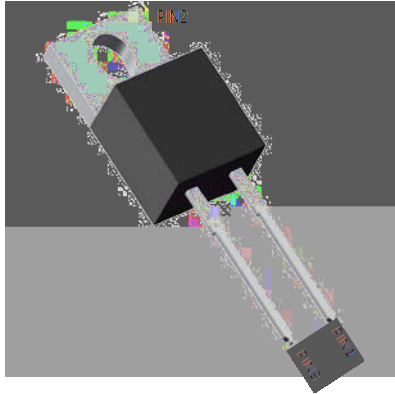

Features

- Adopt FRED chip
- Low forward Voltage drop
- Fast reverse recovery time
- High frequency operation
- High purity, high temperature epoxy encapsulation for enhanced mechanical strength and moisture resistance
- Guard ring for enhanced ruggedness and long term reliability

Typical Applications

Typical applications are in switching power supplies, converters, freewheeling diodes, and reverse battery protection.

Mechanical Data

Package: TO-220AC

Molding compound meets UL 94 V-0 flammability rating, RoHS-compliant

Terminals: Tin plated leads, solderable per J-STD-002 and JESD22-B102

Dimensions: 4.0 D, i a d

	SYMBOL	UNIT	MUR1660
Device marking code			MUR1660
Repetitive Peak Reverse Voltage	V_{RRM}	V	600
Average Rectified Output Current @60Hz sine wave, R-load, Tc(FIG.1)	I_o	A	16
Surge(Non-repetitive)Forward Current @60Hz half sine-wave, 1 cycle, Tj=25	I_{FSM}	A	150
Current Squared Time @1ms t 8.3ms Tj=25	I^2t	A ² s	93
Storage Temperature	T_{stg}		-55 ~ +175
Junction Temperature	T_j		-55 ~ +175
Typical Junction capacitance @4V,1MHz	C_j	pF	98



MUR1660

Electrical Characteristics

PARAMETER	SYMBOL	UNIT	TEST CONDITIONS	Min	Typ	Max
Instantaneous forward voltage drop per diode	V_{FM}	V	$I_{FM}=16.0A$ @ $T_j=25$	-	1.45	1.6
			$I_{FM}=16.0A$ @ $T_j=150$	-	1.25	1.50
DC reverse current at rated DC blocking voltage per diode	I_{RRM1}	uA	$V_{RM}=V_{RRM}$ $T_j=25$	-	-	5.0
	I_{RRM2}		$V_{RM}=V_{RRM}$ $T_j=150$	-	30	200

Reverse Recovery Time

T_{RR}

MUR1660



MUR1660

Outline Dimensions

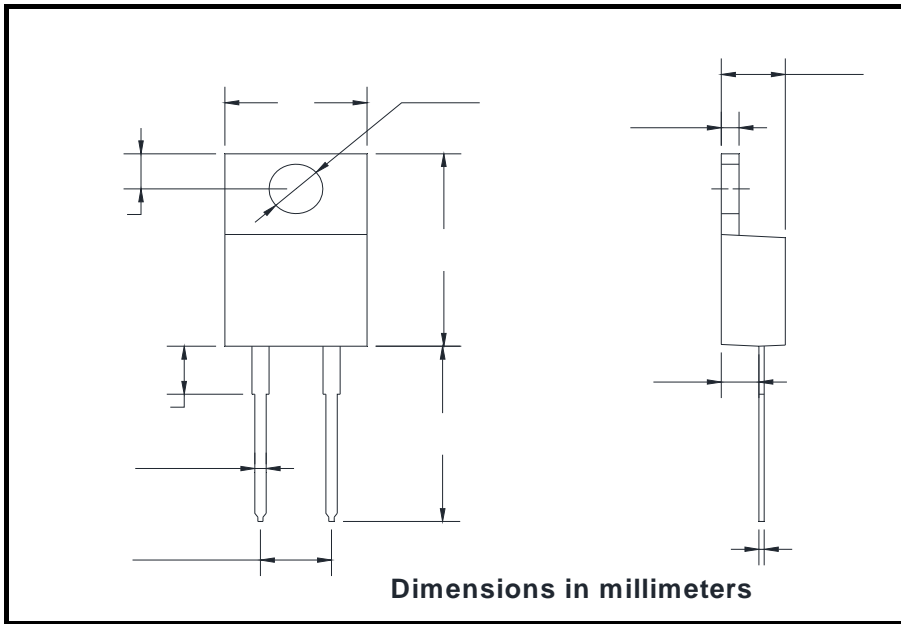

TO-220AC		
Dim	Min	Max
A	9.95	10.35
B	2.55	2.95
C	3.75	4.05
D	14.95	15.25
E	3.75	4.25
F	0.26	0.5
G	0.68	0.94
H	13.3	13.9
I	4.86	5.26
J	4.38	4.78
K	1.14	1.4
L	2.37	2.79



Disclaimer

The information presented in this document is for reference only. Yangzhou Yangjie Electronic Technology Co., Ltd. reserves the right to make changes without notice for the specification of the products displayed herein to improve reliability, function or design or otherwise.

The product listed herein is designed to be used with ordinary electronic equipment or devices, and not designed to be used with equipment or devices which require high level of reliability and the malfunction of which would directly endanger human life (such as medical instruments, transportation equipment, aerospace machinery, nuclear-reactor controllers, fuel controllers and other safety devices), Yangjie or anyone on its behalf, assumes no responsibility or liability for any damages resulting from such improper use of sale.

This publication supersedes & replaces all information previously supplied. For additional information, please visit our website [http:// www.21yangjie.com](http://www.21yangjie.com) , or consult your nearest Yangjie's sales office for further assistance.