



N-Channel Enhancement Mode Field Effect Transistor

Product Summary

V_{DS}	100V
I_D	60A
$R_{DS(ON)}$ (at $V_{GS}=10V$)	8.6 mohm
$R_{DS(ON)}$ (at $V_{GS}=4.5V$)	13 mohm
100% EAS Tested	
100% V_{DS} Tested	

General Description

Split gate trench MOSFET technology
 Excellent package for heat dissipation
 High density cell design for low $R_{DS(ON)}$
 Moisture Sensitivity Level 1
 Epoxy Meets UL 94 V-0 Flammability Rating
 Halogen Free

Applications

High Frequency Switching
 Synchronous Rectification

Absolute Maximum Ratings ($T_A=25$ unless otherwise noted)

Parameter		Symbol	Limit	Unit
Drain-source Voltage		V_{DS}	100	V
Gate-source Voltage		V_{GS}	± 20	V
Drain Current	$T_C=25$	I_D	60	A
	$T_C=100$		38	
Pulsed Drain Current ^A		I_{DM}	240	A
Avalanche energy ^B		EAS	200	mJ
Total Power Dissipation ^C	$T_C=25$	P_D	88	W
	$T_C=100$		35.2	
Junction and Storage Temperature Range		T_J, T_{STG}	-55 +150	

Thermal resistance

Parameter		Symbol	Typ	Max	Units
Thermal Resistance Junction-to-Ambient ^D	t 10S	R	15	20	/W
Thermal Resistance Junction-to-Ambient ^D	Steady-State		40	50	



YJG60G10B

RECOMMEND
YJG60G10C
FOR NEW DESIGN

Electrical Characteristics ($T_J=25$ unless otherwise noted)

Parameter	Symbol	Conditions	Min	Typ
-----------	--------	------------	-----	-----



Typical Performance Characteristics

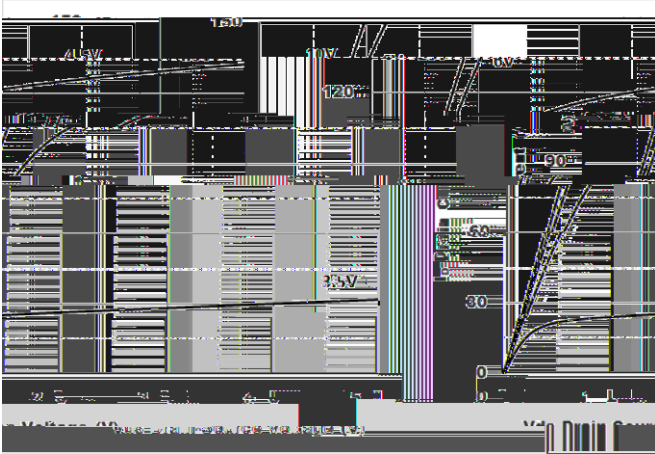

Figure1. Output Characteristics

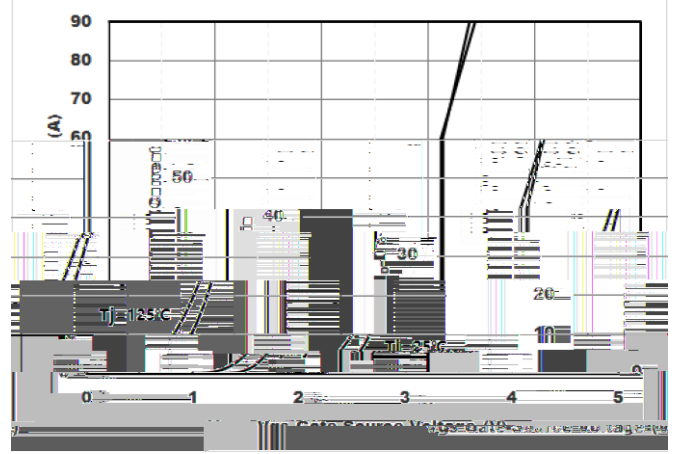

Figure2. Transfer Characteristics

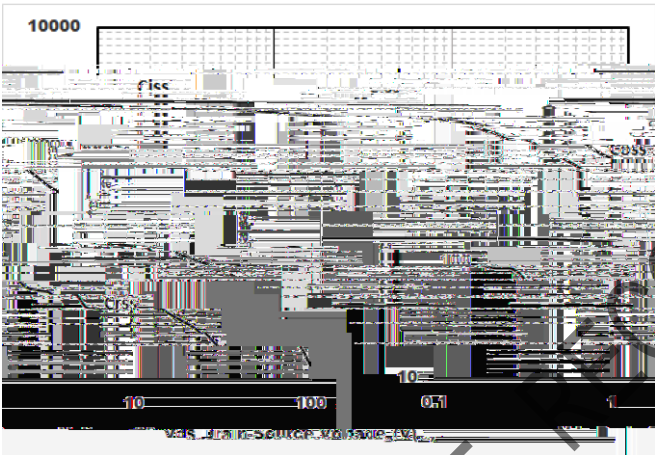

Figure3. Capacitance Characteristics

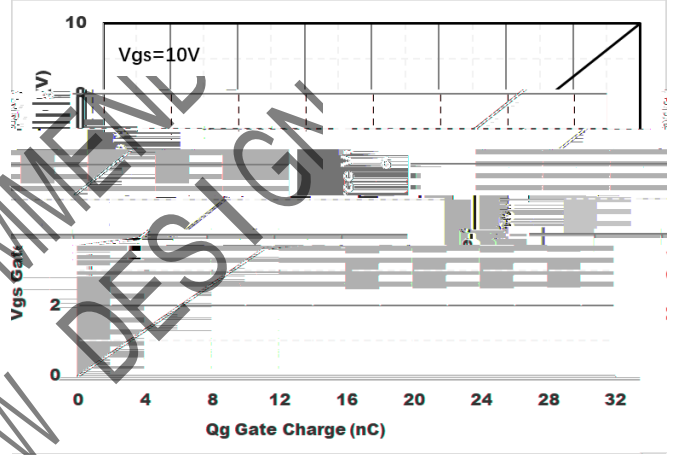

Figure4. Gate Charge

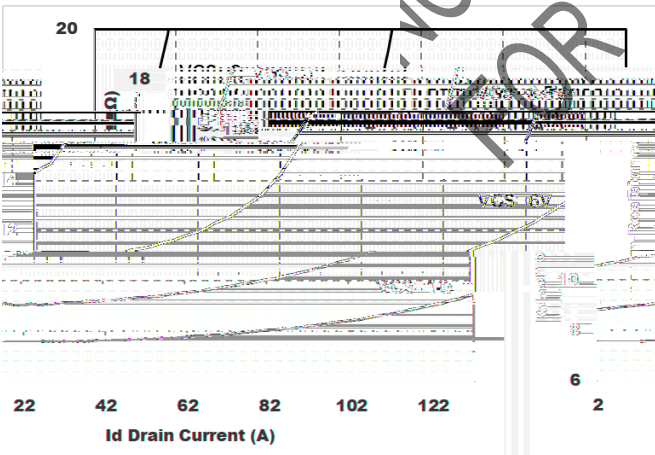

Figure5. : On-Resistance vs. Gate to Source Voltage

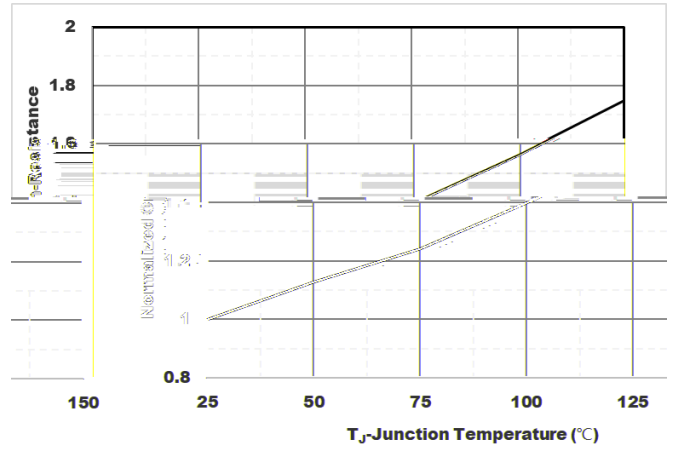

Figure6. Normalized On-Resistance



Figure7. Drain current

Figure8.Safe Operation Area



YJG60G10B

RECOMMEND
YJG60G10C
FOR NEW DESIGN

PDFN5060-8L-B-1.1MM Package information

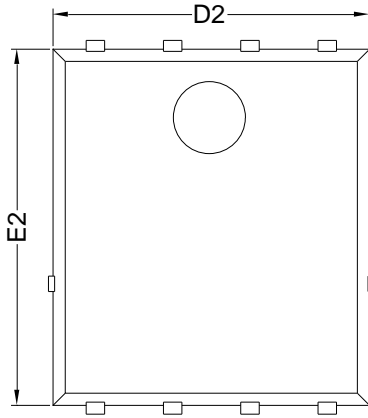

Top View

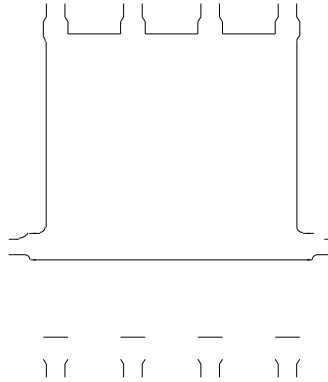

Bottom View

Side View

SYMBOL	MILLIMETER		
	MIN	NOM	MAX
D	5.15	5.35	5.55
E	5.95	6.15	6.35
A	1.00	1.10	1.20
A1	0.254 BSC		
A2			0.10
D1	3.92	4.12	4.32
E1	3.52	3.72	3.92
D2	5.00	5.20	5.40
E2	5.66	5.86	6.06
E3	0.254 REF		
E4	0.21 REF		
L1	0.56	0.66	0.76
L2	0.50 BSC		
b	0.31	0.41	0.51
e	1.27 BSC		

Note:

1. Controlling dimension: in millimeters.
2. General tolerance: ± 0.10 mm.
3. The pad layout is for reference purposes only.



Disclaimer

The information presented in this document is for reference only. Yangzhou Yangjie Electronic Technology Co., Ltd. reserves the right to make changes without notice for the specification of the products displayed herein to improve reliability, function or design or otherwise.

The product listed herein is designed to be used with ordinary electronic equipment or devices, and not designed to be used with equipment or devices which require high level of reliability and the malfunction of which would directly endanger human life (such as medical instruments, transportation equipment, aerospace machinery, nuclear-reactor controllers, fuel controllers and other safety devices), Yangjie or anyone on its behalf, assumes no responsibility or liability for any damages resulting from such improper use of sale.

This publication supersedes & replaces all information previously supplied. For additional information, please visit our website [http:// www.21yangjie.com](http://www.21yangjie.com)

NOT RECOMMEND
FOR NEW DESIGN